

The courses and distances  
down the river from White-  
Thorn to Sugartree down the  
river.

- N. 70 E. 59.5 ps.
- N. 68 E. 40
- N. 25 E. 12
- N. 18 E. 28

To Sugartree down the river.

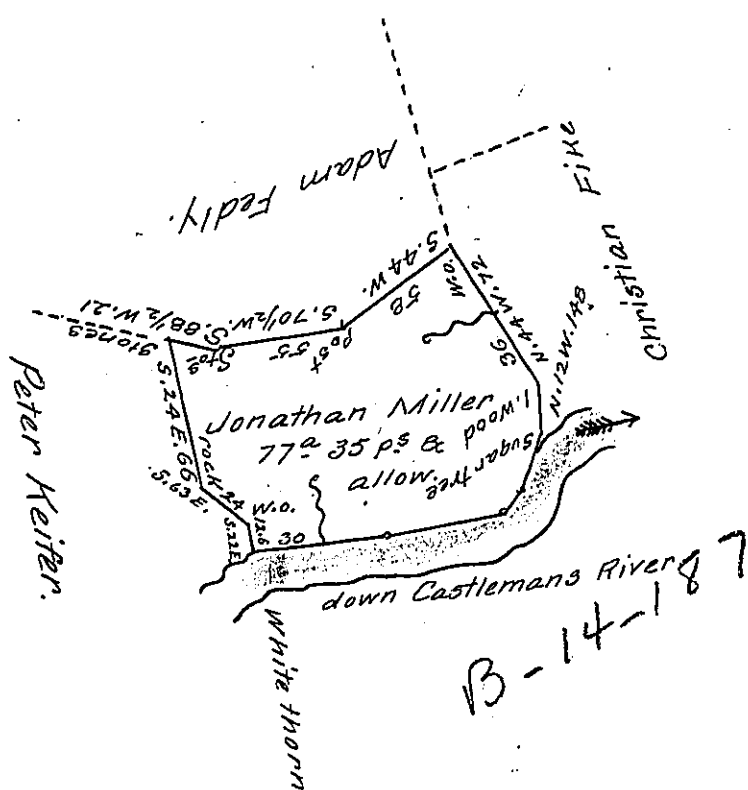

Situate on the north side of Castleman's River in EHLICK Township Somerset  
County and surveyed the 7<sup>th</sup> day of March 1813, in pursuance of a Warrant  
granted unto Jonathan Miller dated the 11<sup>th</sup> day of December 1812

Pr. John M. Clean Deputy -

To Andrew Porter Esquire

Surveyor General of Pennsylvania

Note, when this survey was made there was about 20<sup>a</sup> of Land Cleared & fenced,  
a House & Barn thereon & said Miller and family residing on said premises  
which improvement appears to correspond in date with his application

Jno M. Clean, D.S.

IN TESTIMONY that the above is a copy of the original remaining on file in  
the Department of Internal Affairs of Pennsylvania, made  
conformably to an Act of Assembly approved the 16th day of  
February, 1833, I have hereunto set my Hand and caused  
the Seal of said Department to be affixed at Harrisburg,  
this fourth day of January 1906.

*Luca N. Brown*  
Secretary of Internal Affairs.